

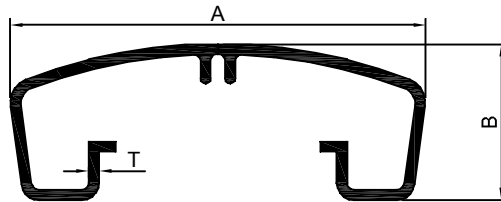

HAND RAIL



Section No.	A	B	T	Weight in Kg. / 12 ft.
2805	65.00	30.50	1.20	2.300-2.600
2806	65.00	30.50	1.50	2.600-3.200
2808	65.00	30.50	2.00	3.500-4.000

VENETION BLIND TOP

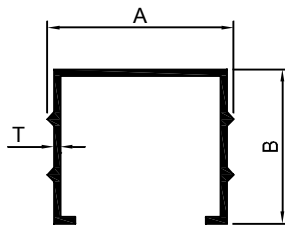

Section No.	A	B	T	Weight in Kg. / 12 ft.
2879	28.00	25.00	1.00	0.750-0.850



A TYPE HAND RAIL

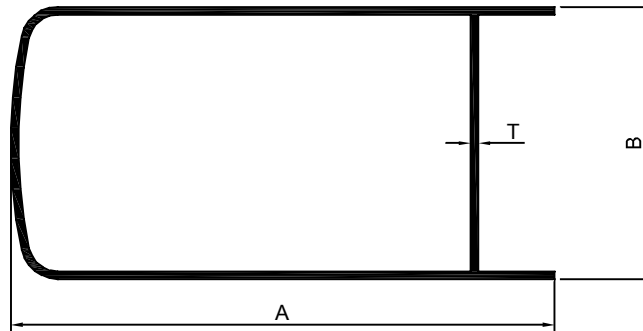

Section No.	A	B	T	Weight in Kg. / 12 ft.
2809	88.90	44.45	1.25	3.250-3.750

4 " HAND RAIL

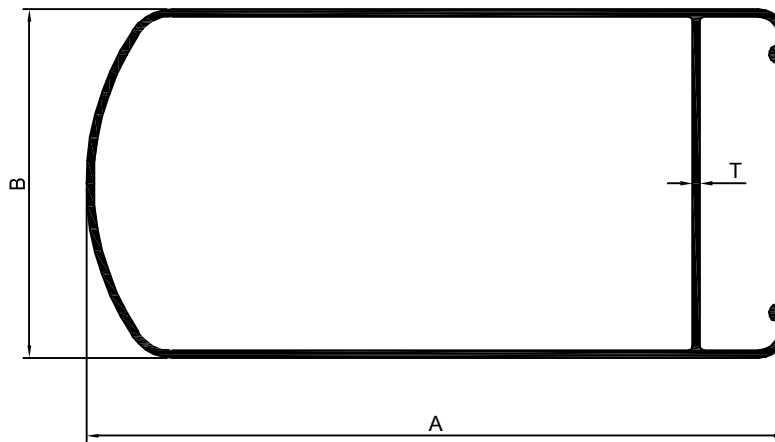

Section No.	A	B	T	Weight in Kg. / 12 ft.
2820	101.60	50.80	1.20	3.250-3.750